

Mirage Grand Ballroom Dimensions

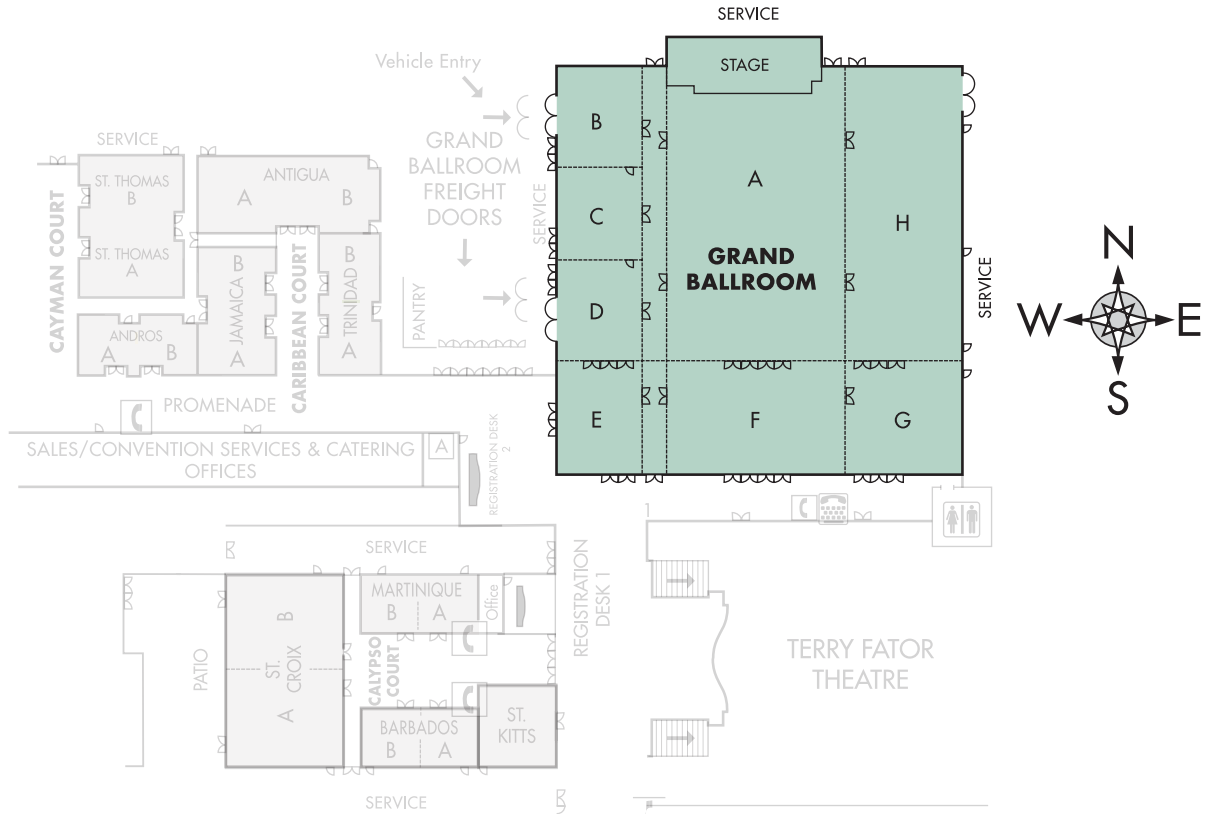

Dimensions

	Square Feet	Dimensions L & W	Ceiling Height
Grand Ballroom	40,000	200' x 200'	24'
Grand Ballroom A	12,232	139' x 88'	24'
Grand Ballroom B	1,980	45' x 44'	24'
Grand Ballroom C	1,980	45' x 44'	24'
Grand Ballroom D	2,200	50' x 44'	24'
Grand Ballroom E	2,640	60' x 44'	24'
Grand Ballroom F	5,280	60' x 88'	24'
Grand Ballroom G	3,360	60' x 56'	24'
Grand Ballroom H	7,784	139' x 56'	24'
Recessed Stage	2,652	78' x 34'	N/A

Capacities Part 1

	Grand Ballroom	A	B	C	D
Theatre	3,600	1,080	170	170	180
School Room	2,200	760	110	110	130
Hollow Square	N/A	140	55	55	60
U-Shape	N/A	110	45	45	45
Cone	N/A	110	35	35	40
Cocktail reception	2,700	900	130	130	140
Banquet	2,550	770	110	110	120
8'x10' Exhibits	245	70	10	10	10
10'x10' Exhibits	210	65	10	10	10

Capacities Part 2

	E	F	G	H	Recessed Stage
Theatre	205	465	280	650	N/A
School Room	145	285	190	400	N/A
Hollow Square	70	100	70	110	N/A
U-Shape	55	80	55	100	N/A
Cone	50	70	50	110	N/A
Cocktail reception	180	360	225	520	N/A
Banquet	150	300	200	440	N/A
8'x10' Exhibits	12	26	17	45	N/A
10'x10' Exhibits	12	26	13	32	N/A